

INSERTI FILETTATI CILINDRICI GODRONATI INOX A4 - TESTA RIDOTTA



KNURLED CYLINDRICAL A4 STAINLESS STEEL THREADED INSERTS - REDUCED COUNTERSUNK HEAD

INSERTS FILETÉS CRANTÉS CYLINDRIQUES ACIER INOX A4 - TÊTE RÉDUITE

BLINDNIETMUTTERN RUNDSCHAFT GERÄNDELT EDELSTAHL A4 - KLEINER SENKKOPF

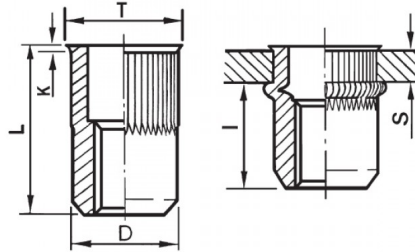
TUERCAS REMACHABLES CILINDRICAS ESTRIADAS INOX A4 - CABEZA REDUCIDA



	S GRIP	D +0,07/-0,1		T +/-0,5	K +/-0,15	L +/-0,5	I ~	
M8	0.5-3.0	10,9	11	12	0,7	16,5	10,5	20

MATERIAL: STAINLESS STEEL A4

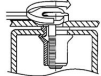
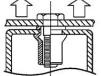
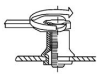
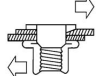
 MAX TIGHTENING TORQUE (Nm) 20	 PULL-OUT FORCE (N) 25000	 TORQUE TO TURN (Nm) 4,5	 SHEAR FORCE (N) 4400
--	---	--	---

Disegno di proprietà della Fixi S.r.l. - Non può essere copiato, riprodotto o comunicato a terze persone senza autorizzazione.
Drawing owned by Fixi S.r.l.- It cannot be copied, reproduced or communicated to third parties without permission.

Disegnato da / Designed by: Ufficio Tecnico
Ufficio Tecnico / Tech Office: tech@fixi.it

22/12/2024

CODICE PRODOTTO / PART NUMBER

85IXA4ITRGM08C

FIXI[®]

FIXI s.r.l. Via Bellardi 40/A
10146 - Torino (Italy)
www.fixi.it - info@fixi.it