

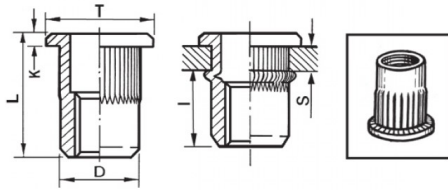



INSERTI FILETTATI CILINDRICI GODRONATI ACCIAIO - TESTA TONDA
KNURLED CYLINDRICAL STEEL THREADED INSERTS - FLAT HEAD
INSERTS FILETÉS CRANTÉS CYLINDRIQUES ACIER - TÊTE CYLINDRIQUE
BLINDNIETMUTTERN RUNDSCHAFT GERÄNDELT STAHL- FLACHKOPF
TUERCAS REMACHABLES CILINDRICAS ESTRIADAS ACERO - CABEZA PLANA



ZIGRINATO SOTTO LA TESTA
KNURLED UNDERNEATH THE HEAD

|  | S GRIP | D +0,07/-0,1 |  +0,1-0 | T +/-0,5 | K +/-0,15 | L +/-0,5 | I ~ |  |
|---|------------------|------------------------|---|--------------------|---------------------|--------------------|---------------|---|
| M12 | 1 - 4 | 14.9 | 15 | 18 | 1.7 | 22 | 13.5 | 80 |

MATERIAL: STEEL ZINC PLATED CR III

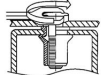
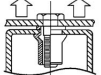
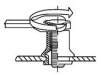
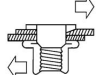
| | | | |
|--|---|---|---|
|  MAX TIGHTENING TORQUE (Nm) 80 |  PULL-OUT FORCE (N) 34000 |  TORQUE TO TURN (Nm) 30 |  SHEAR FORCE (N) 6500 |
|--|---|---|---|

Disegno di proprietà della Fixi S.r.l. - Non può essere copiato, riprodotto o comunicato a terze persone senza autorizzazione.
 Drawing owned by Fixi S.r.l.- It cannot be copied, reproduced or communicated to third parties without permission.

Disegnato da / Designed by: Ufficio Tecnico
Ufficio Tecnico / Tech Office: tech@fixi.it

09/03/2025

CODICE PRODOTTO / PART NUMBER

85ACITTGM12C15

FIXI®

FIXI s.r.l. Via Bellardi 40/A
 10146 - Torino (Italy)
 www.fixi.it - info@fixi.it