

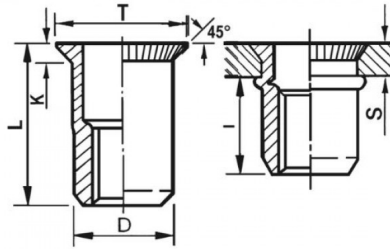



INSERTI FILETTATI CILINDRICI - TESTA SVASATA
CYLINDRICAL THREADED INSERTS - COUNTERSUNK HEAD
INSERTS FILETÉS CYLINDRIQUES - TÊTE FRAISÉE
BLINDNIETMUTTERN RUNDSCHAFT - SENKKOPF
TUERCAS REMACHABLES CILINDRICAS - CABEZA AVELLANADA



	S	D		T	K	L	I	
	GRIP	+0,07/-0,1	+0,1/-0	+/-0,5	+/-0,15	+/-0,5	~	
M5	1.5 - 3.5	6.9	7	10	1.5	13	7.8	8

MATERIAL: STAINLESS STEEL A2

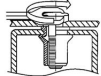
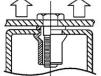
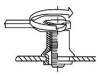
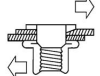
			
MAX TIGHTENING TORQUE (Nm)	PULL-OUT FORCE (N)	TORQUE TO TURN (Nm)	SHEAR FORCE (N)
8	11500	1,5	2000

Disegno di proprietà della Fixi S.r.l. - Non può essere copiato, riprodotto o comunicato a terze persone senza autorizzazione.
 Drawing owned by Fixi S.r.l.- It cannot be copied, reproduced or communicated to third parties without permission.

Disegnato da / Designed by: Ufficio Tecnico
Ufficio Tecnico / Tech Office: tech@fixi.it

12/03/2025

CODICE PRODOTTO / PART NUMBER

85IXITSM05C

FIXI®

FIXI s.r.l. Via Bellardi 40/A
 10146 - Torino (Italy)
 www.fixi.it - info@fixi.it