

INSERTI FILETTATI SEMIESAGONALI CIECHI - TESTA RIDOTTA

SEMI-HEXAGONAL THREADED INSERTS CLOSED END TYPE - REDUCED COUNTERSUNK H.

INSERTS FILETÉS SEMI-HEXAGONAUX BORGNES - TÊTE RÉDUITE

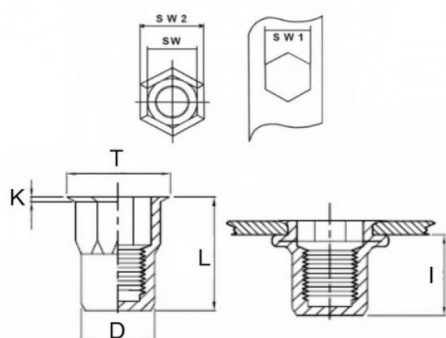

BLINDNIETMUTTERN TEILSECHSKANT GESCHLOSSEN - KLEINER SENKKOPF

TUERCAS REMACHABLES SEMI-HEXAGONALES CIEGAS - CABEZA REDUCIDA



K dopo la posa
K after setting



|  | GRIP | SW1 +0,01/-0 | SW +0,07/-0,1 | T +/-0,5 | K +/-0,15 | L +/-0,5 | I |  |
|---|-----------|-----------------|------------------|-------------|--------------|-------------|-----|---|
| M3 | 0.5 - 1.5 | 5 | 4,9 | 6 | 0.5 | 13 | 8,5 | 2 |

MATERIAL: STAINLESS STEEL A2

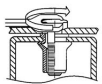
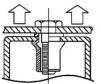
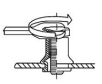
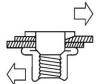
| | | | |
|---|--|--|--|
|  MAX TIGHTENING TORQUE (Nm) 1 |  PULL-OUT FORCE (N) 3900 |  TORQUE TO TURN (Nm) 0,4 |  SHEAR FORCE (N) 900 |
|---|--|--|--|

Disegno di proprietà della Fixi S.r.l. - Non può essere copiato, riprodotto o comunicato a terze persone senza autorizzazione.
Drawing owned by Fixi S.r.l.- It cannot be copied, reproduced or communicated to third parties without permission.

Disegnato da / Designed by: Ufficio Tecnico
Ufficio Tecnico / Tech Office: tech@fixi.it

26/12/2024

CODICE PRODOTTO / PART NUMBER

85IXIERSECM03C

FIXI®

FIXI s.r.l. Via Bellardi 40/A
10146 - Torino (Italy)
www.fixi.it - info@fixi.it