

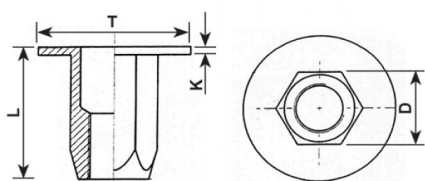



**INSERTI FILETTATI SPECIALI ACCIAIO**  
**SPECIAL STEEL THREADED INSERTS**  
**INSERTS FILETÉS SPÉCIAUX ACIER**  
**SONDERANFERTIGUNGEN STAHL**  
**INSERTOS ROSCADOS ESPECIALES ACERO**



	<b>S</b> GRIP	<b>D</b> +0,07-0,1		<b>T</b> +0,5	<b>K</b> +0,15	<b>L</b> +0,5	
M6	0.5 - 3	8.9	9.1	18	1.5	16	15

**MATERIAL:** STEEL ZINC PLATED CR III

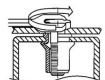
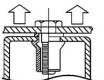
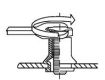
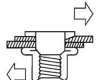
			
MAX TIGHTENING TORQUE (Nm) 15	PULL-OUT FORCE (N) 16500	TORQUE TO TURN (Nm) 4,5	SHEAR FORCE (N) 3000

Disegno di proprietà della Fixi S.r.l. - Non può essere copiato, riprodotto o comunicato a terze persone senza autorizzazione.  
 Drawing owned by Fixi S.r.l.- It cannot be copied, reproduced or communicated to third parties without permission.

**Disegnato da / Designed by:** Ufficio Tecnico  
**Ufficio Tecnico / Tech Office:** tech@fixi.it

31/12/2024

**CODICE PRODOTTO / PART NUMBER**

85ACITLEM06

**FIXI®**

FIXI s.r.l. Via Bellardi 40/A  
 10146 - Torino (Italy)  
 www.fixi.it - info@fixi.it